

Hs1 Hs2 Hs3 Hs4 Hs5

## Hexa Pendant Lights

A series of Hexa pendants available in five different shapes. Hs1, Hs2, Hs3, Hs4, Hs5.

The lamps are meant to be hung from the ceiling, for indoor use mainly. Each form is designed and cut digitally, assembled afterwards. Each lamp is assembled in a unique way.

The shapes are made of thin 0,3 translucent plastic, thus their weight is very little, around 0,5-1 kg. Despite the softness of the material, the structure, which is a hexagonal system, creates a firm, even form. At the intersections of the hexagons the elements display star-like shapes, which combine together and overlap, thus a very interesting surface structure is achieved.

### Product description & measurements

Diffused light that provides good general light in the room.

Type: Pendant Light

Material: Plastic

Colour: Opal White

Ceiling Rose

Diameter: 12.5 cm / 4.92 in

Colour: White

Material: Polypropylene plastic

Cable lenght

250cm / 98 in electrical cord

Cable colour: white striped cable

Bulb spec

E27 bulb holder

Recommends low-energy bulb(max 40W)

Avoid the use of conventional bulbs, they may overheat.

Compact Fluorescent(CFL), or LED lights

E27 - 16W,20W,23W,32W

CFL E27-32W = 150W Standard incandescent

CFL E27-16W = 80W Standard incandescent

Packaging(m)(H,W,D)

Hs1	0.55	0.35	0.35
Hs2	0.35	0.55	0.55
Hs3	0.25	0.60	0.60
Hs4	0.45	0.40	0.40
Hs5	0.70	0.30	0.30

Product Code

Hs1 Hs1W35

Hs2 Hs2W55

Hs3 Hs3W60

Hs4 Hs4W40

Hs5 Hs5W30

Weight (kg)

max 1 kg

Dimensions (cm/in)

Hs1 Ø 35 cm/13.78" H 55cm/21.65"

Hs2 Ø 55 cm/21.65" H 35 cm/13.78"

Hs3 Ø 60 cm/23.62" H 25 cm/9.84"

Hs4 Ø 40 cm/15.74" H 45 cm/17.71"

Hs5 Ø 30 cm/11.81" H 70 cm/27.55"

Cleaning Instructions

Dust the lamp with a duster.

Installation

Designed to be easily installed.

The package includes the complete installation instructions

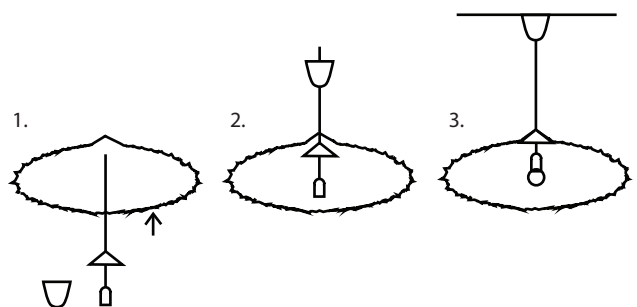

If you have any questions about a product orders@adamlamp.com